

MOUNT KENNETT PLACE, HENRY ST. LIMERICK

Excel Centre Offices From 300 sq. ft. To 10,000 sq. ft.



Description: Ground and first floor office unit extending to 10,000 sq. ft. The unit lends itself to an open plan or subdivision layout.

Location: The unit fronts on to Mount Kennett Place which links Henry St. and the Dock Rd. it is adjacent to Aviary Car Park and the Prometric driving theory test centre.

Details: The unit is currently in a partial shell finish. All utility services are available. A full fit-out package option is also available

Car Parking: Onsite car parking available. A number of car parking packages can be included as part of an overall rental package including, free or discounted customer and staff parking.

Rent: Units available to rent from 300 sq. ft. subject to lease/lease denied on a long lease basis, minimum 5 years in a shell finish or fully fitted.
Shell finish from €9.00 per sq. ft.
Additional turn key fit-out packages from €2.50 to €5.00 per sq. ft.

Rates: The property is currently not rated

Contact: Aviary Estates Ltd.

Mount Kennett Court,

Dock Rd.

Limerick

Phone: 061 318288

Fax: 061 318069

Email: peter.madden@aviary.ie

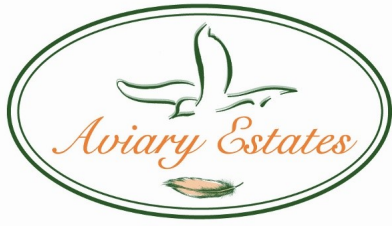

Location



Excel Centre - Ground Floor Layout

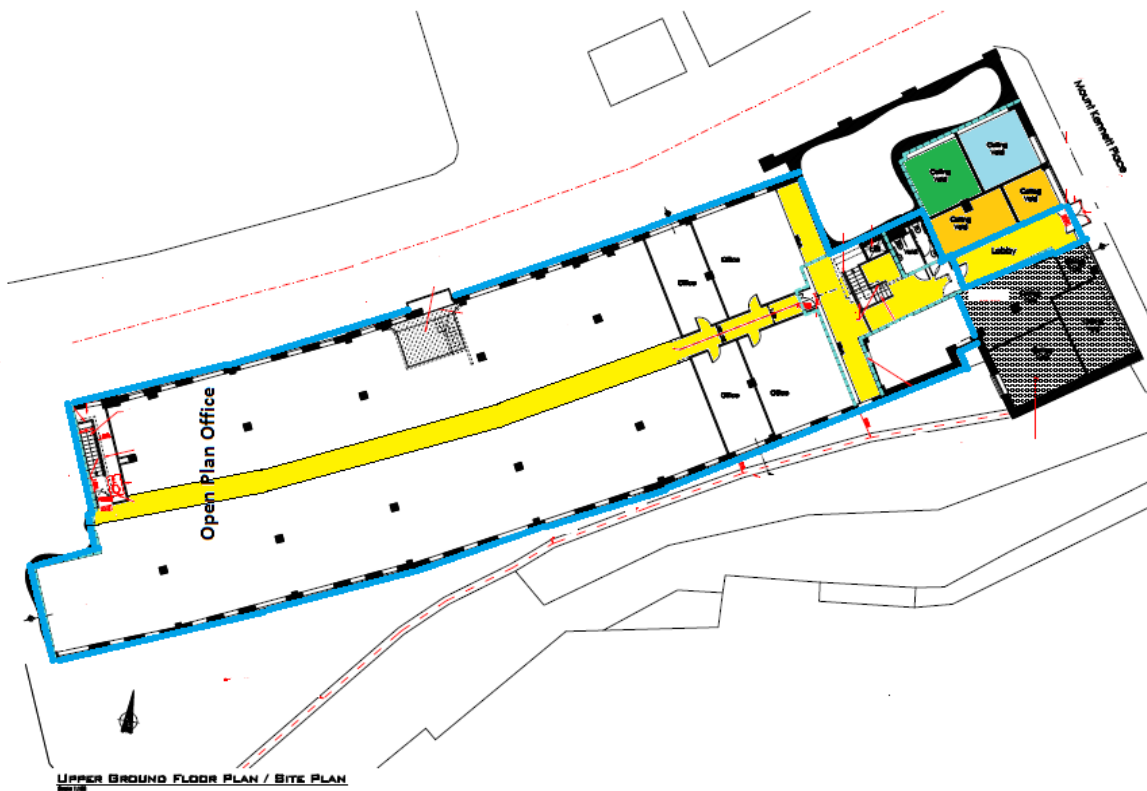

Custom Fit-Out Options available



Excel Centre Occupiers

1. Prometric
2. Concern
3. Activ Season
4. Korrekt Computers
5. To Let

Phone: 061 318288

Fax: 061 318069

Email: peter.madden@aviary.ie